

The Evolution - LU/LA Low Rise Commercial Elevator



Opposite Opening Car

The Limited Use/Limited Application (LU/LA) elevator was developed to provide an additional type of vertical transportation for today's accessibility marketplace. It bridges the gap between the commercial elevator and the vertical platform lift. The LU/LA has the look and feel of a large commercial elevator but on a smaller scale.

National Wheel-O-Vator's LU/LA, the Evolution, has been designed to meet the requirements of ASME A17.1 and ICC/ANSI A117.1. It allows the architect or specifier to take the guesswork out of integrating this type of elevator into their application. Typical applications include schools, libraries, low rise commercial buildings, churches and multi-family housing.



90 Degree Opening Car

National Wheel-O-Vator provides the functionality of a commercial elevator with the elegance and warmth of a residential elevator. Our optional handcrafted wood interior walls are manufactured in a variety of hardwoods, such as Cherry, Maple, Hickory, Oak, Birch, Alder and others.



Single Opening - Std.

A 90 degree car is an available option when you purchase an Evolution. The car itself is offered with a 51" x 51" clear car with 36" sliding doors. Placing an Evolution in your project has now become *easier than ever*.

Our goal at National Wheel-O-Vator is to provide solutions that address architectural barrier issues, thus making access available for all persons. Please call us at 1-800-968-5438 or visit www.wheelovator.com.



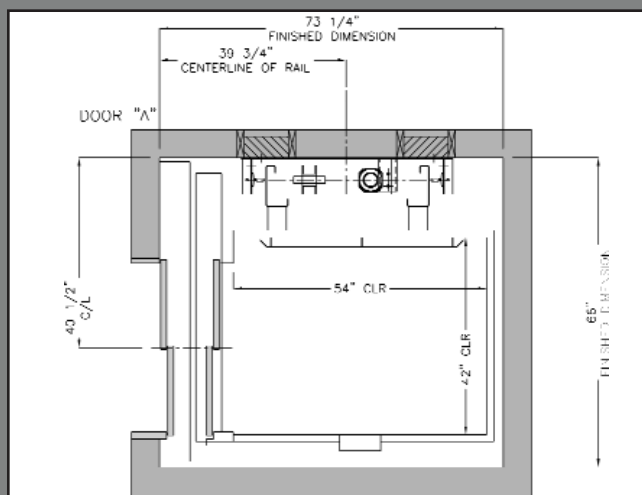

Single Opening

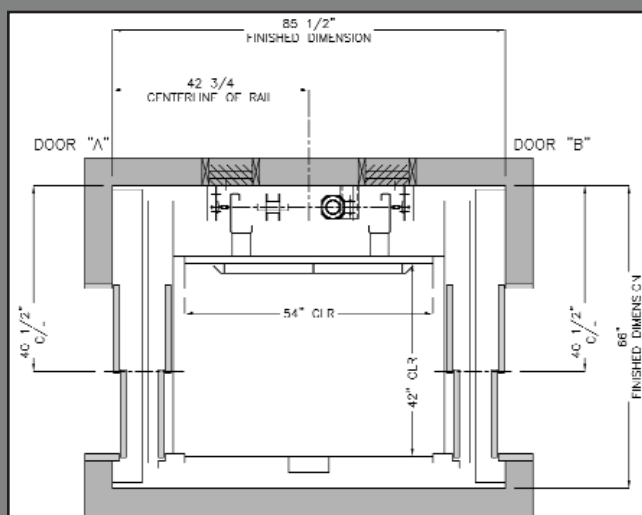

Opposite Opening

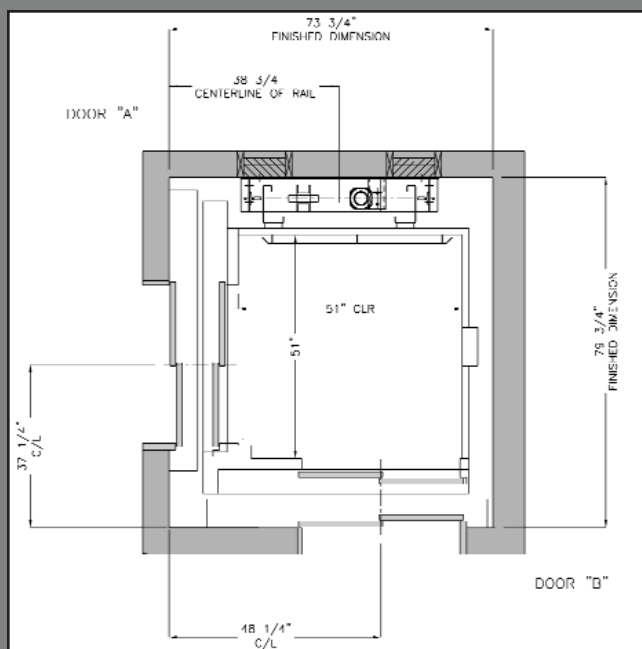

90 Degree Opening

Drive System

- 1:2 Roped hydraulic drive system

Configurations

- Single opening - 42" x 54" car size (standard)
- Opposite opening - 42" x 54" car size
- 90 degree opening - 51" x 51" car size (only)

Doors

- 36" wide doors
- Automatic, horizontally sliding, two-speed hoistway and car doors

Features

- 1400 lb. capacity
- Travel up to 25'
- Pit depth
 - 38"- standard
 - less than 38" to 14" (with alternative means)
 - (Pits over 35" require extra space for pit ladder)
- Overhead requirement
 - 11' (refuge space) - standard
 - 9'6" (alternative means)
- Rated speed: 30 fpm
- Controller: selective collective microprocessor
- Brushed Stainless Steel Car Operating Panel and Hall Calls
- Safety descent - bottom terminal floor
- Emergency lighting and alarm button
- Car and hall call acknowledgement lights
- Speed governor and/or overspeed valve
- Handrail
- Tactile/Braille characters; audible and visual signals
- Homing timer
- Full height photo electric screen
- 2 year limited parts warranty
- Buffer springs

Options

- ADA phone
- Fire service phase 1 and 2
- 42" x 60" or 48" x 54" car size
- Travel up to 35' with variance
- 32" wide doors (62" wide hoistway)
- Pit ladder (additional hoistway space required)
- Custom car sizes
- Wood and stainless steel car interiors
- Suspended ceiling with translucent panels